

MATERIAL NOTES:

1. SYNTHETIC FILTER FABRIC SHALL CONTAIN ULTRAVIOLET RAY INHIBITORS AND STABILIZERS TO PROVIDE A MINIMUM OF 6 MONTHS OF EXPECTED USABLE CONSTRUCTION LIFE AT A TEMPERATURE RANGE OF 0 DEGREES TO 120 DEGREE F. SYNTHETIC FILTER FABRIC SHALL BE CERTIFIED BY THE MANUFACTURER OR SUPPLIER AS CONFORMING TO THE FOLLOWING REQUIREMENTS:

FABRIC PROPERTIES	MIN. ACCEPTED VALUE	TEST METHOD
GRAB TENSILE STRENGTH (lbs)	90	ASTM D1682
ELONGATION FAILURE AT (%)	50	ASTM D1682
MULLEN BURST STRENGTH (PSI)	190	ASTM D3786
PUNCTURE STRENGTH (lbs)	40	ASTM D751 (MODIFIED)
SLURRY FLOW RATE (gal/min/sf)	0.3	
EQUIVALENT OPENING SIZE	40-80	US STD SIEVE CW-02215
ULTRAVIOLET RADIATION STABILITY (%)	90	ASTM G-26

2. THE HEIGHT OF THE SILT FENCE SHALL NOT EXCEED 36 INCHES.
3. THE FILTER FABRIC SHALL BE PURCHASED IN A CONTINUOUS ROLL CUT TO THE LENGTH OF THE BARRIER TO AVOID THE USE OF JOINTS. WHEN JOINTS ARE NECESSARY, FILTER CLOTH SHALL BE SPLICED TOGETHER ONLY AT SUPPORT POSTS, WITH A 6 INCH OVERLAP MINIMUM AND SHALL BE SECURELY SEALED.

INSTALLATION NOTES:

1. WHEN STANDARD STRENGTH FILTER FABRIC IS USED, A WIRE MESH SUPPORT FENCE SHALL BE FASTENED SECURELY TO THE UPSLOPE SIDE OF THE POSTS USING HEAVY DUTY WIRE STAPLES AT LEAST ONE (1) INCH LONG, TIE WIRES, OR HOG RINGS. THE WIRE SHALL EXTEND NO MORE THAN 36 INCHES ABOVE THE ORIGINAL GROUND SURFACES.
2. THE "STANDARD STRENGTH" FILTER FABRIC SHALL BE STAPLED OR WIRED TO THE FENCE, AND EIGHT (8) INCHES OF THE FABRIC SHALL BE EXTENDED INTO THE TRENCH. FILTER FABRIC SHALL NOT BE STAPLED TO EXISTING TREES.
3. WHEN EXTRA STRENGTH FILTER FABRIC AND CLOSER POST SPACING ARE USED, THE WIRE MESH SUPPORT FENCE MAY BE ELIMINATED. IN SUCH A CASE, THE FILTER FABRIC IS STAPLED OR WIRED DIRECTLY TO THE POSTS WITH ALL OTHER PROVISIONS APPLYING.
4. SILT FENCES SHALL BE REMOVED WHEN THEY HAVE SERVED THEIR USEFUL PURPOSE, BUT NOT BEFORE THE UPSLOPE AREA HAS BEEN PERMANENTLY STABILIZED.
5. POSTS SHALL BE SPACED A MAXIMUM OF 10 FEET APART AND DRIVEN SECURELY INTO THE GROUND.

INSPECTION AND MAINTENANCE NOTES:

1. SILT FENCE BARRIERS SHALL BE INSPECTED IMMEDIATELY AFTER EACH RAINFALL AND AT LEAST DAILY DURING PROLONGED RAINFALL. THEY SHALL BE REPAIRED IF THERE ARE ANY SIGNS OF EROSION OR SEDIMENTATION BELOW THEM. ANY REQUIRED REPAIRS SHALL BE MADE WITHIN 24 HOURS OF CONTRACTOR NOTIFICATION. IF THERE ARE SIGNS OF UNDERCUTTING AT THE CENTER OR THE EDGES, OR IMPOUNDING OF LARGE VOLUMES OF WATER BEHIND THEM, SEDIMENT BARRIERS SHALL BE REPLACED WITH A TEMPORARY CHECK DAM.
2. SHOULD THE FABRIC ON A SILT FENCE DECOMPOSE OR BECOME INEFFECTIVE PRIOR TO THE END OF THE EXPECTED USABLE LIFE AND THE SILT FENCE IS STILL NECESSARY, THE FABRIC SHALL BE REPLACED PROMPTLY.
3. SEDIMENT DEPOSITS SHOULD BE REMOVED WHEN DEPOSITS REACH APPROXIMATELY ONE THIRD (1/3) THE HEIGHT OF THE SILT FENCE.
4. ANY SEDIMENT DEPOSITS REMAINING IN PLACE AFTER THE SILT FENCE IS NO LONGER REQUIRED SHOULD BE DRESSED TO CONFORM TO THE EXISTING GRADE, PREPARED, AND SEEDED.
5. MAINTENANCE SHALL BE PERFORMED AS NEEDED AND MATERIAL REMOVED WHEN "BULGES" IN THE SILT FENCES DEVELOP.

SILT FENCE DETAIL SCALE: NTS

EROSION AND SEDIMENT CONTROL NOTES — GENERAL

ALL SOIL EROSION AND SEDIMENT CONTROL MEASURES SHALL BE IN ACCORDANCE WITH THE STANDARDS AND PRINCIPLES AS OUTLINED IN THE "NEW YORK STATE STANDARDS AND SPECIFICATIONS FOR EROSION AND SEDIMENT CONTROL" AND THE LOCAL MUNICIPALITY'S EROSION AND SEDIMENT CONTROL STANDARDS AND PRACTICES, IF SUCH A DOCUMENT EXISTS. THE INTENT OF THE OUTLINED MEASURES IS TO MINIMIZE EROSION AND SEDIMENTATION DURING CONSTRUCTION, STABILIZE AND PROTECT THE SITE FROM EROSION AFTER CONSTRUCTION IS COMPLETE AND MITIGATE ANY ADVERSE IMPACTS TO STORMWATER QUALITY RESULTING FROM SEDIMENT RUNOFF CAUSED BY DEVELOPMENT ACTIVITIES.

NO SOIL STOCKPILE OR GRADED AREA SHALL REMAIN EXPOSED FOR MORE THAN 14 DAYS. THE EXPOSED AREAS OR SOIL STOCKPILE SHALL BE STABILIZED WITHIN THE 14 DAY PERIOD. STABILIZATION MEASURES TO BE USED INCLUDE TEMPORARY SEEDING, PERMANENT SEEDING, MULCHING AND STONE RIP RAP. DURING CONSTRUCTION, RUNOFF SHALL BE DIVERTED AROUND THE SITE WITH EARTH DIKES, PIPING, OR STABILIZED CHANNELS WHERE POSSIBLE. SHEET RUNOFF FROM THE SITE SHALL BE PROVIDED WITH BARRIER FILTERS. STONE RIP RAP SHALL BE PROVIDED AT THE OUTLETS OF DRAINAGE PIPES WHERE EROSION VELOCITIES ARE ENCOUNTERED.

TIMING OF CONTROL MEASURES

ALL EROSION AND SEDIMENT CONTROL MEASURES SHALL BE INSTALLED PRIOR TO COMMENCING ANY CLEARING OR GRADING OF THE SITE. STRUCTURAL CONTROLS SHALL BE INSTALLED CONCURRENTLY WITH THE APPLICABLE ACTIVITY, AREAS WHERE CONSTRUCTION ACTIVITY TEMPORARILY CEASES FOR MORE THAN TWENTY ONE (21) DAYS WILL BE STABILIZED WITH A TEMPORARY SEED AND MULCH WITHIN FOURTEEN (14) DAYS OF THE LAST DISTURBANCE. ONCE CONSTRUCTION ACTIVITY CEASES PERMANENTLY IN AN AREA, SILT FENCES WILL BE REMOVED ONCE PERMANENT MEASURES AND STABILIZATION ARE ESTABLISHED.

GENERAL INSPECTION AND MAINTENANCE PRACTICE

THESE ARE THE GENERAL INSPECTION AND MAINTENANCE PRACTICES THAT WILL BE USED TO IMPLEMENT THE PLAN DURING CONSTRUCTION.

1. THE SMALLEST PRACTICAL PORTION OF THE SITE WILL BE DISTURBED AT ONE TIME.
2. ALL CONTROL MEASURES WILL BE INSPECTED AT LEAST ONCE EACH WEEK.
3. ALL MEASURES WILL BE MAINTAINED IN GOOD WORKING ORDER. IF A REPAIR IS NECESSARY IT WILL BE INITIATED WITHIN 24 HOURS.
4. THE CONTRACTOR IS RESPONSIBLE FOR THE INSTALLATION AND MAINTENANCE OF ALL EROSION AND SEDIMENT CONTROL MEASURES THROUGHOUT THE COURSE OF CONSTRUCTION.

INSTALLATION NOTES

1. TEMPORARY SEEDING SHOULD BE MADE WITHIN 24 HOURS OF CONSTRUCTION OR DISTURBANCE. IF NOT, THE SOIL MUST BE SCARIFIED PRIOR TO SEEDING.
2. IN ORDER FOR MULCH TO BE EFFECTIVE IT MUST BE PLACED PRIOR TO MAJOR STORM EVENTS. IT WILL BE NECESSARY TO CLOSELY MONITOR WEATHER PREDICTIONS TO HAVE ADEQUATE WARNING OF SIGNIFICANT STORMS.
3. THE TIME PERIOD TO MULCH CAN RANGE FROM 14 TO 21 DAYS OF INACTIVITY ON AN AREA, THE LENGTH OF TIME VARYING WITH SITE CONDITIONS. PROFESSIONAL JUDGMENT SHALL BE USED TO EVALUATE THE INTERACTION OF SITE CONDITIONS (SOIL ERODIBILITY, SEASON OF YEAR, EXTENT OF DISTURBANCE, PROXIMITY TO SENSITIVE RESOURCES, ETC.) AND THE POTENTIAL IMPACT OF EROSION ON ADJACENT AREAS IN ORDER TO CHOOSE AN APPROPRIATE TIME RESTRICTION.
4. WHEN MULCH IS APPLIED TO PROVIDE PROTECTION OVER WINTER (PAST THE GROWING SEASON) IT SHALL BE AT THE RATE OF 6,000 LBS OF HAY OR STRAW PER ACRE. A TACKIFIER MAY BE ADDED TO THE MULCH.

SEDIMENT BARRIERS SHALL BE INSTALLED PRIOR TO ANY SOIL DISTURBANCE OF THE CONTRIBUTING DRAINAGE AREA ABOVE THEM. (REFER TO CONSTRUCTION SEQUENCING SCHEDULE IN SWPPP REPORT FOR FURTHER INFORMATION).

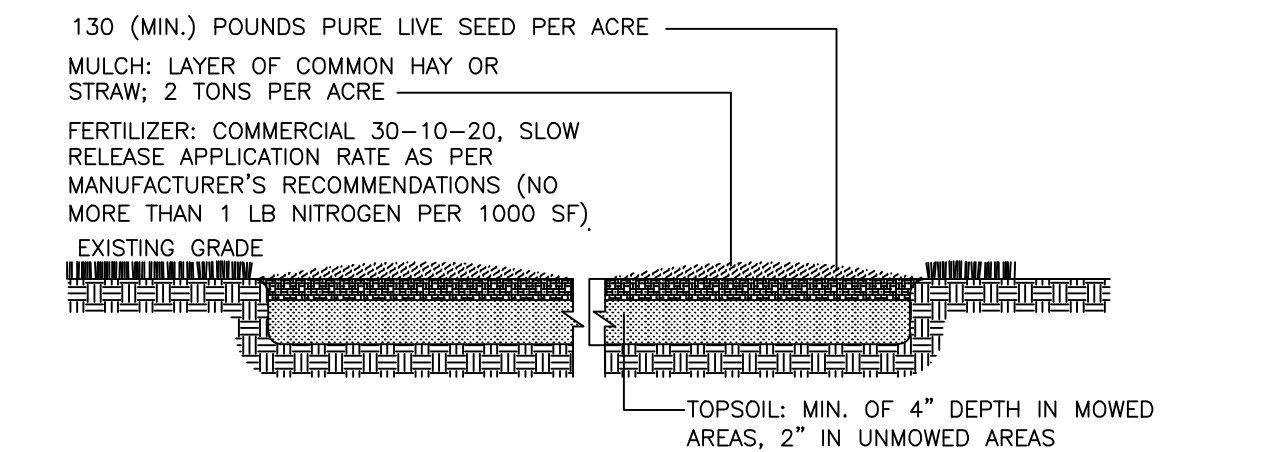

SEEDING NOTES:

1. PROVIDE FRESH, CLEAN, NEW SEED COMPLYING WITH ESTABLISHED TOLERANCES FOR GERMINATION AND PURITY IN ACCORDANCE WITH THE U.S. DEPARTMENT OF AGRICULTURE RULES AND REGULATIONS UNDER THE LATEST EDITION OF THE FEDERAL SEED ACT. SEED SHALL BE MIXED BY THE DEALER AND SHALL BE DELIVERED TO THE SITE IN SEALED CONTAINERS WHICH SHALL BEAR THE DEALER'S GUARANTEE ANALYSIS.
2. SEED MIXTURES:
FOR TEMPORARY SEEDING — OR — AREAS THAT WILL NOT BE MAINTAINED:
RAPIDLY GERMINATING ANNUAL RYEGRASS: 30 LBS PER ACRE PERENNIAL RYEGRASS: 100 LBS PER ACRE CEREAL RYE: 30 LBS PER ACRE
FOR USE ON LAWN AREAS (AREAS TO BE MAINTAINED):
ALTERNATE A (SUNNY SITE)
85% KENTUCKY BLUE GRASS BLEND: 85-114 LBS PER ACRE
20% PERENNIAL RYEGRASS: 26-35 LBS PER ACRE
15% FINE FESCUE: 19-26 LBS PER ACRE
TOTAL: 130-175 LBS PER ACRE
ALTERNATE B (SHADY SITE)
80% KENTUCKY BLUE GRASS BLEND*: 105-138 LBS PER ACRE
20% PERENNIAL RYEGRASS: 25-37 LBS PER ACRE
TOTAL: 130-175 LBS PER ACRE
* SHADE TOLERANT

3. APPLY SEED UNIFORMLY BY HAND, CYCLONE SEEDER, OR HYDRO SEEDER (SLURRY INCLUDING SEED AND FERTILIZER). HYDRO SEEDINGS, WHICH INCLUDE MULCH, MAY BE LEFT ON SOIL SURFACE. SEEDING RATES MUST BE INCREASED 10% WHEN HYDRO-SEEDING.
4. MULCH SEEDED AREAS WITH STRAW MULCH (2000 LBS PER ACRE).
5. IRRIGATE TO FULLY SATURATE SOIL LAYER, BUT NOT TO DISLODGE PLANTING SOIL.
6. SEED BETWEEN APRIL 1ST AND MAY 15TH OR AUGUST 15TH AND OCTOBER 15TH. SEEDING MAY OCCUR BETWEEN MAY 15TH AND AUGUST 15TH IF ADEQUATE IRRIGATION IS PROVIDED.

TOPSOIL APPLICATION NOTES:

1. TOPSOIL SHALL BE DISTURBED TO A UNIFORM DEPTH OVER THE AREA. IT SHALL NOT BE PLACED WHEN IT IS PARTIALLY FROZEN, MUDDY OR ON FROZEN SLOPES OVER ICE, SNOW OR STANDING WATER.
2. TOPSOIL PLACED AND GRADED ON SLOPES STEEPER THAN 5% SHALL BE PROMPTLY FERTILIZED, SEEDED AND STABILIZED BY "TRACKING" WITH SUITABLE EQUIPMENT.
3. APPLY TOPSOIL IN THE FOLLOWING AMOUNTS FOR INTENDED USE:
MOWED LAWN: 4-8 INCHES
UNMOWED AREA: 2-4 INCHES
4. COMPLETE ROUGH GRADING AND FINAL GRADE, ALLOWING FOR DEPTH OF TOPSOIL TO BE ADDED. SCARIFY ALL COMPACT, SLOWLY PERMEABLE, MEDIUM AND FINE TEXTURED SUBSOIL AREAS. SCARIFY AT APPROXIMATELY RIGHT ANGLES TO THE SLOPE DIRECTION IN SOIL AREAS THAT ARE STEEPER THAN 5%.
5. REMOVE REFUSE, WOODY PLANT PARTS, STONES OVER 3 INCHES IN DIAMETER, AND OTHER LITTER.

TOPSOIL MATERIAL NOTES:

THE FURNISHINGS OF NEW TOPSOIL SHALL BE OF A BETTER OR EQUAL QUALITY OF THE EXISTING ADJACENT TOPSOIL AND SHALL MEET THE FOLLOWING CRITERIA:

- TOPSOIL SHALL HAVE AT LEAST 2%, BUT NOT MORE THAN 6% BY WEIGHT OF FINE TEXTURED STABLE ORGANIC MATERIAL.
- TOPSOIL SHALL HAVE NOT LESS THAN 20% FINE TEXTURED MATERIAL (PASSING THE NO. 200 SIEVE) AND NOT MORE THAN 15% CLAY.
- TOPSOIL SHALL BE RELATIVELY FREE OF STONES OVER 1" DIAMETER, THRASH, NOXIOUS WEEDS, AND WILL HAVE LESS THAN 10% GRAVEL BY VOLUME.

INSPECTION & MAINTENANCE NOTES:

1. TEMPORARY SEEDING AND PLANTING WILL BE INSPECTED FOR BARE SPOTS, WASHOUTS, AND UNHEALTHY GROWTH.
2. TEMPORARY SEEDINGS SHALL BE PERIODICALLY INSPECTED, AT A MINIMUM 95% OF THE SOIL SURFACE SHOULD BE COVERED BY VEGETATION. IF ANY EVIDENCE OF EROSION OR SEDIMENTATION IS APPARENT, REPAIRS SHALL BE MADE AND OTHER TEMPORARY MEASURES USED IN THE INTERIM.
3. AERATE COMPACTED OR HEAVY USED AREAS, ANNUALLY AS SOON AS THE SOIL MOISTURE CONDITIONS PERMIT.
4. RESEED BARE AND THIN AREAS WITH ORIGINAL SPECIES.
5. SOIL SHALL MAINTAIN A PH OF 6.0-7.0.

TOPSOIL, SEED AND MULCH DETAIL SCALE: NTS

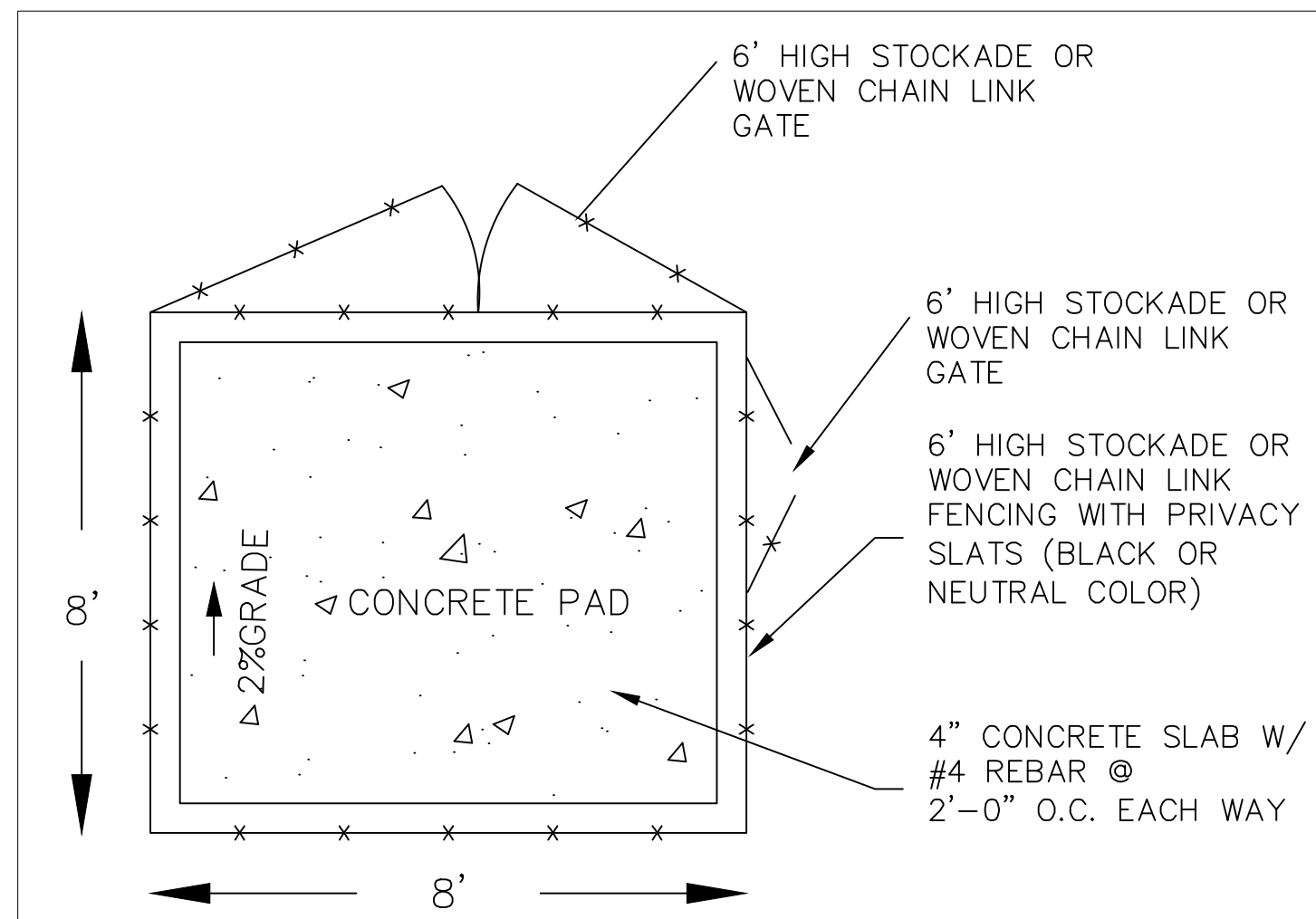

TYPICAL DUMPSTER ENCLOSURE NOT TO SCALE

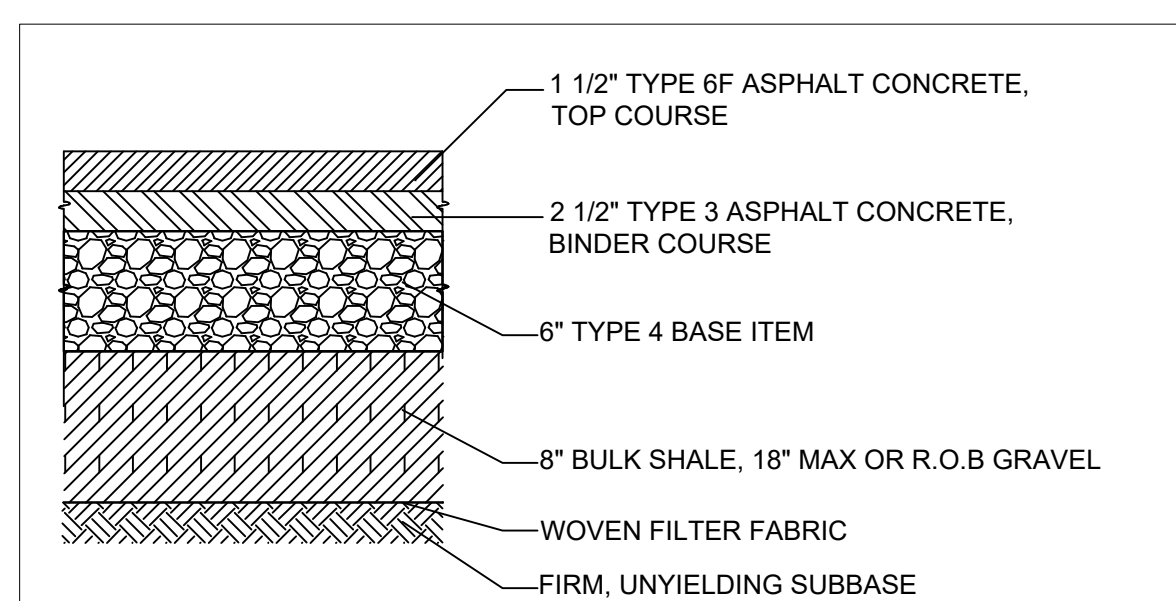

X-SECTION VIEW COMMERCIAL PAVEMENT DETAIL Not to Scale

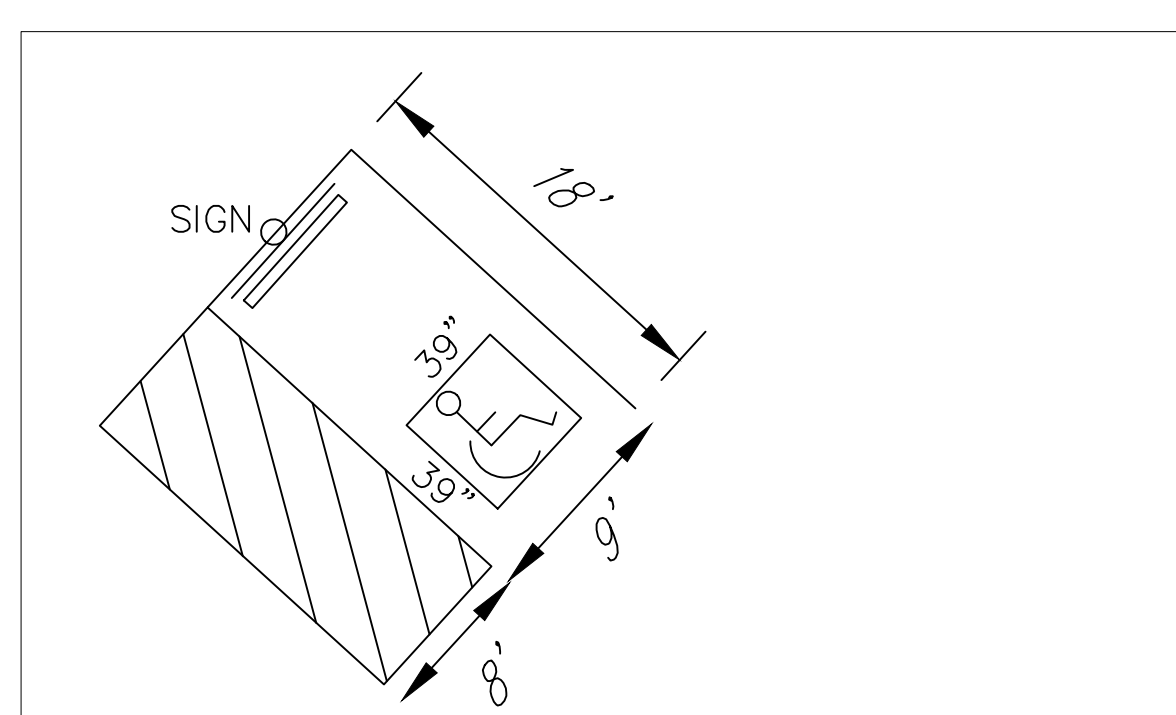

PAVEMENT MARKINGS TO BE IN ACCORDANCE WITH DIMENSIONS SHOWN IN TOWN CODE SECTION 100-29(G)

HANDICAP PARKING DETAIL NTS

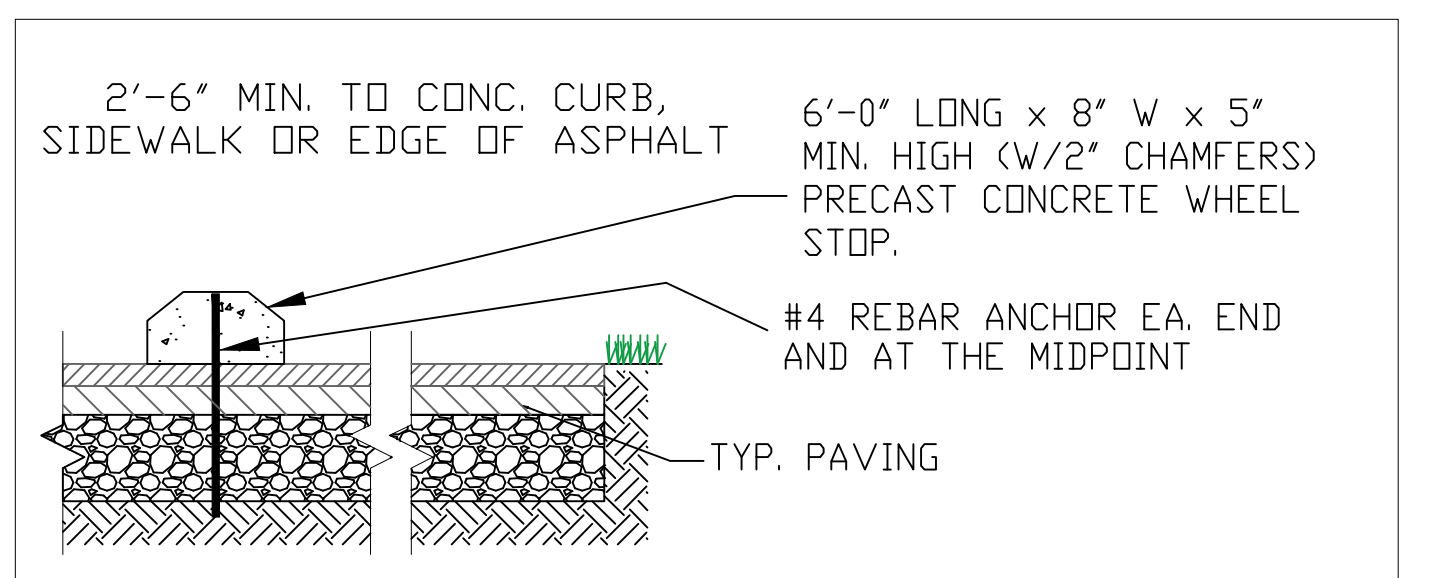

PRECAST CONCRETE WHEEL STOP NTS

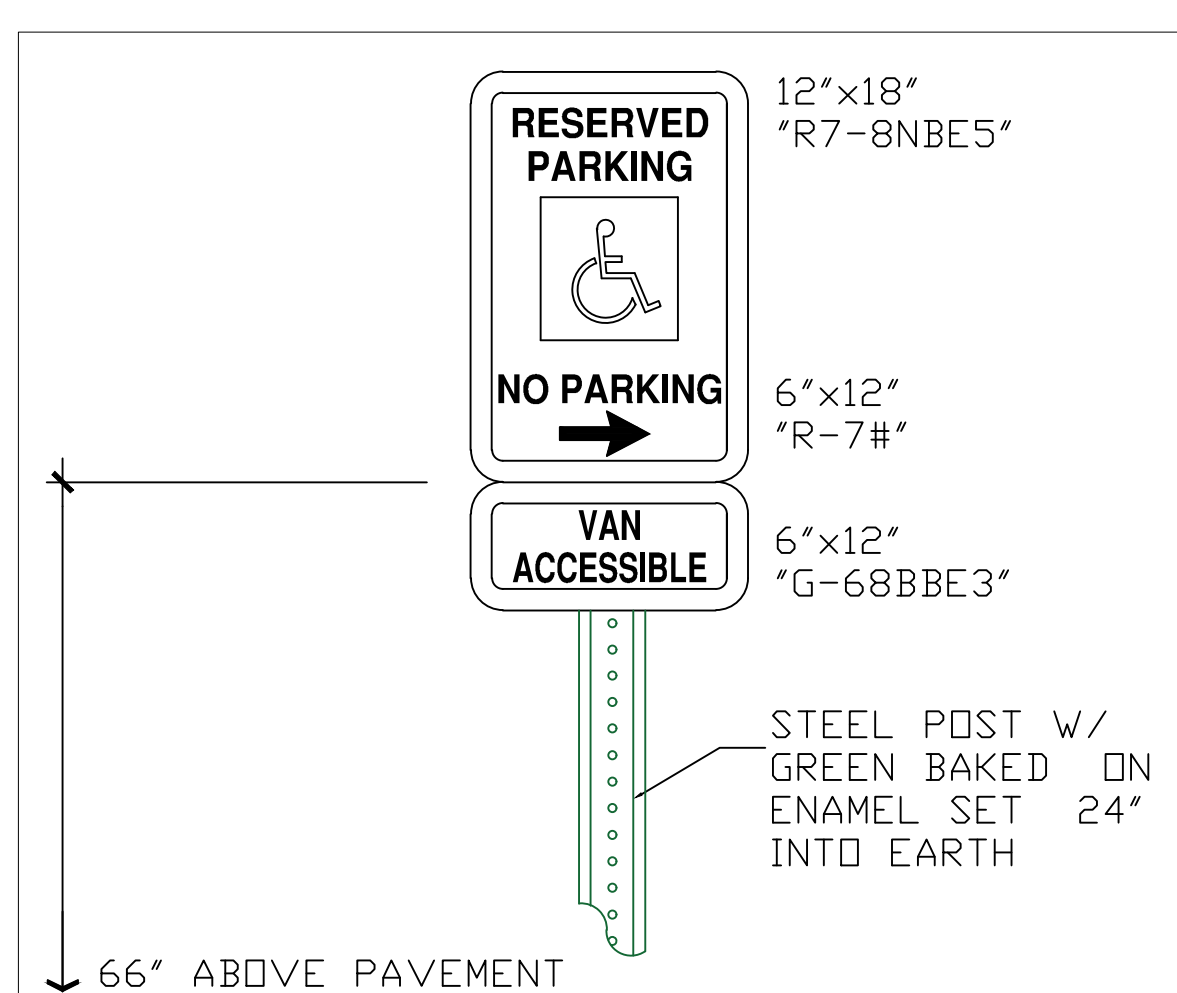

ACCESSIBLE SIGN DETAIL NTS

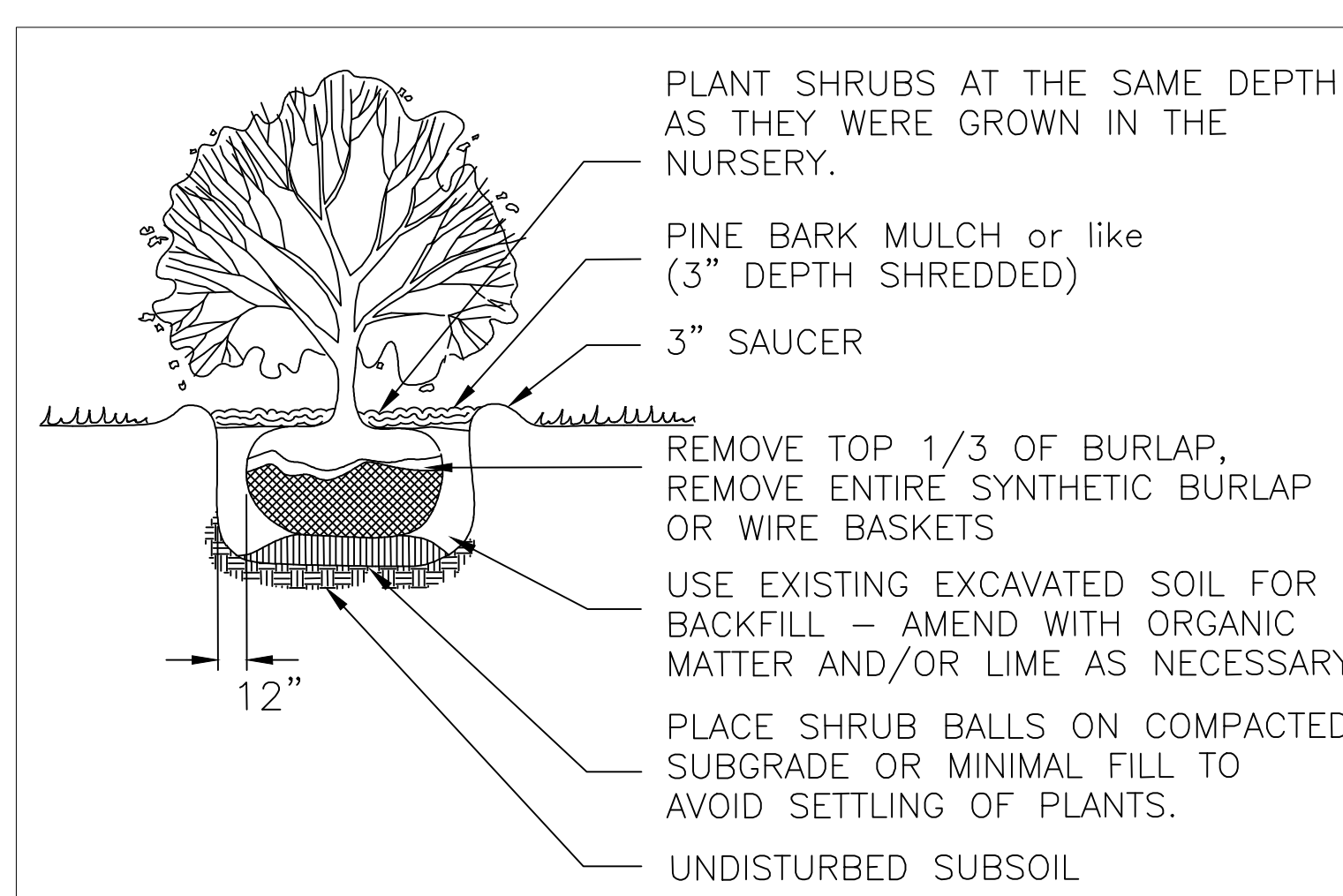

TYPICAL SHRUB PLANTING DETAILS SUGGESTED INSTALLATION SPECIFICATIONS FOR STATIC SLICING

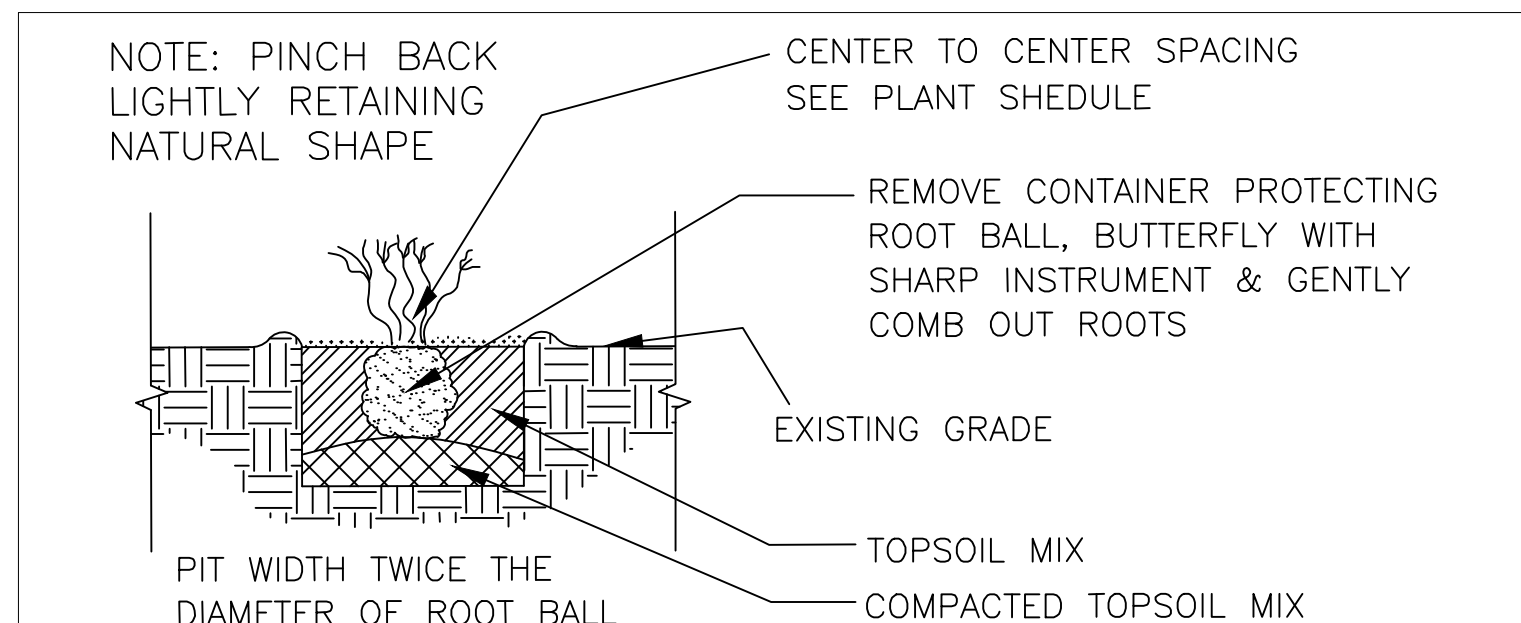

TYPICAL ORNAMENTAL GRASS DETAIL SUGGESTED INSTALLATION SPECIFICATIONS FOR STATIC SLICING

I HEREBY CERTIFY THAT THIS MAP IS A TRUE REPRESENTATION OF A SURVEY PERFORMED BY THIS OFFICE IN THE FIELD ON 21 OCTOBER, 2025 IN ACCORDANCE WITH THE EXISTING CODES OF PRACTICE AS ADOPTED BY THE NEW YORK STATE ASSOCIATION OF PROFESSIONAL LAND SURVEYORS.

PATRICIA PAULI BROOKS, LS
NEW YORK PROFESSIONAL LAND SURVEYOR #49795

NO.	ADDRESS PLANNING BOARD COMMENTS	NA	GIO	P.P.B.	4-08-26
1	DESCRIPTION OF REVISION	FIELD CREW	DRAWN	APPROVED	DATE

FIELD DATE: 10-21-25
FIELD BOOK NO: HV# 25
FIELD BOOK PG: PG 7

FIELD CREW: ED/DD
DRAWN: GIO

REVIEWED: S.D.
APPROVED: P.P.B.
DATE: 03-05-2026
SCALE: NTS
FILE NO: 12-230295-02
DWG. NO: 2 OF 2

SITE PLAN DETAILS PREPARED FOR
TRUNCALI REALTY, LLC
SBL: 88.17-8-23
TOWN OF LLOYD
COUNTY OF ULSTER, STATE OF NEW YORK

CONTROL POINT ASSOCIATES INC P.C.
11 MAIN STREET
HIGHLAND, NY 12528
845.691.7339
WWW.CPASURVEY.COM

WARREN, NJ 08090-0000
CHARLOTTE, NC 28203-0000
NEW LAFAYETTE, LA 70507-0000
MANASSAS, VA 20108-0000
LONG ISLAND, NY 11761-0000
SOUTH BRIDGEFIELD, MA 01468-0000
ALBANY, NY 12210-0000
ROCKY HILL, CT 06151-0000
FT. LAUDERDALE, FL 33304-0000

CONTROL POINT ASSOCIATES INC. P.C. - ALL RIGHTS RESERVED. THE EXPLORE, OR REPRODUCE OR TRANSMIT IN ANY FORM OR BY ANY MEANS, WITHOUT THE WRITTEN PERMISSION OF CONTROL POINT ASSOCIATES INC. IS PROHIBITED.

THE STATE OF NEW YORK REQUIRES NOTIFICATION BY EXAMINATORS, DESIGNERS, OR ANY PERSON PREPARING TO DISTURB THE EARTH'S SURFACE ANYWHERE IN THE STATE.

